



SISTER CONCERN of RODDUR APPARELS LTD UNIT-1, RODDUR APPARELS LTD UNIT-2

**100% Export Oriented Knit Garments Industry**



**HEAD OFFICE**

ADDRESS: House- 288, Road- 04, 1<sup>st</sup> floor,  
Baridhara DOHS, Dhaka  
Bangladesh  
CONTACT: +880 1713046497  
MAIL: [hossain@ratoollapparels.com](mailto:hossain@ratoollapparels.com)

**FACTORY:**

**RATOOOL APPARELS LTD.**  
ADDRESS: vangnahati  
Sreepur, Gazipur  
CONTACT: +880 1713046497  
E-MAIL: [hossain@ratoollapparels.com](mailto:hossain@ratoollapparels.com)  
**RODDUR APPARELS LTD. UNIR-1**  
Hariken Road, Gazipur  
**RODDUR APPARELS LTD. UNIR-2**  
Hariken Road, Gazipur

# TABLE OF CONTENTS

About Us .....	3
Production Facilities .....	4
Compliance Issues .....	9
Factory Master Plan .....	13
Garments Range.....	14
List Of Machineries .....	25
Company At A Glance.....	23
List Of Certification .....	24
Client List .....	28
Contact Details.....	30
Factory Location Map.....	31

## ABOUT US

**R**atool Apparel Limited is fully compliant knit fabrics and garments manufacturing and exporting firm located in Sreepur, Gazipur, Bangladesh including another TWO UNITS (RODDUR APPARELS LTD. UNIR-1, RODDUR APPARELS LTD. UNIR-2). Our product range including basic and fashion T-shirt, Polo shirt, Legging, Sportswear, Sleeping-suits, Boxers, Slips etc for Children (Kids & Babies) Women and Men.

The factory is housed in appropriately designed buildings certified to be suitable used as garments manufacturing unit. The building is equipped with necessary structural and fire safety measures required to grow a healthy and fulfilling garments manufacturing environment.

The production floor consists of knitting and garments department. It is equipped with circular knitting machine, Swing Machine, complete CAD, CAM for automatic laying, cutting and pattern making and other textiles machineries. All of the machines are state of the art and have European based origin. Our fabric production capacity is more than 4,500 Tons per year and garments unit production capacity is 16.4 million pieces per year.

At Ratool, we believe that our success resides in valuing our individual customer satisfaction as the topmost priority based on the following cornerstones:

- High quality products.
- On-time shipment.
- Efficient service.

To achieve these we place great emphasis on giving special customized attention to each of our client to accurately determine their individual requirements.

In Ratool, we believe that successful management for any operation requires efficiency, administrative ability and dedication. Our management team is designed and held together with strong root and consists of vast experience in various similar industries which involves co-ordination of people and work process management.

Our people are our biggest asset, as their expertise allows us to serve our buyers effectively and with great inspiration. As a result we always give priority in maintaining a balanced and fulfilling relation between the management team and the workers.

We, at Ratool, pride ourselves as a socially as well as environmentally responsible organization. We aim to achieve sustainable environment through our initiatives to reduce water and carbon consumption.

We are organized by our customer and suppliers as a trustworthy organization. We are striving to deliver high quality products and efficient services. With the combined efforts of our well-practiced management, experienced technicians, skilled workers and highly professional marketing team, we have seen our company growing rapidly over the past years.

Ratool is Wal-mart Yellow approved, Accord Alliance, WRAP, ALDI ASA, BSCI (Business Social Compliance Initiative) and Sedex recognized factory. We are also Oeko - Tex class I certified garments and dyeing manufacturing and Marks & Spencer certified.

# PRODUCTION FACILITIES

The production facility is divided in four different sections and an additional utility facility to support them:

## **KNITTING SECTION**

---

Available Machines: 9 circular Knitting Machine; **Brand:** LISKY TAIWAN

All the machines have Full Feeder Lycra attachment with Lycra feeding units from

Memminger, Germany

**Production Capacity:** 2.5 Tons per day

Fabric: Single Jersey(LY), Pique French Terry, Yarn-Dye Stripe,  
Gros breaker needle.

## **GARMENTS SECTION RATOOL APPARELS LTD.**

---

### **Available Machines:**

### **Cutting Floor:**

- CAD; **BRAND: Winda Germany**
- CAM; **BRAND: Winda, Germany**
- Automatic Spreader 08 Pcs; **BRAND: MAC, Japan**
- Fabric Relax Machine: Winda, China
- Fabric Inspection Machine: UZU Brand, Thailand

**Production Capacity: 30000 Pcs/Day**

### **Sewing Floor:**

- 450 sewing machines (18 lines x 24 m/c per line);

**BRAND: Jhuki, Brother, Pegasus, Japan** (machines selection is such to cover most of the stitching facilities for the knit garments)

**Siruba (China).**

### **Finishing Floor:**

- Thread sucking machines 8 nos,
- Full Steam Iron with vacuum table 18 nos.
- Automatic metal detector machine Brand Lock, UK.

### **Production Capacity:**

One floor, 30,000 pcs per day i.e. **780000 pcs per month**

### **Garments/ Fabric Produced:**

T-shirt, Polo-shirt, Sport wear, Legging, Jogging set, Hoody, Nightwear set, Sweat, Fleece Jacket

T-shirt set, all kinds of basic and fashionable teams for Children (kids and babies), Ladies and Men.

Cotton/Elastin, Mélange, y/d stripe of cotton, viscose, polyester, CVC, PC, Pique.

## GARMENTS SECTION RODDUR APPARELS LTD. UNIT-1

---

### Available Machines:

#### Cutting Floor:

- Automatic Spreader 08 Pcs; **BRAND: MAC, Japan**
- Fabric Relax Machine: Winda, China
- Fabric Inspection Machine: UZU Brand, Thailand.

**Production Capacity: 35,000 Pcs/Day**

#### Sewing Floor:

- 240 sewing machines (10 lines x 24 m/c per line);

**BRAND: Jhuki, Brother, Pegasus, Japan** (machines selection is such to cover most of the stitching facilities for the knit garments)

**Siruba (China).**

#### Finishing Floor:

- Thread sucking machines 8 nos,
- Full Steam Iron with vacuum table 18 nos.
- Automatic metal detector machine Brand Lock, UK.

### Production Capacity:

4 floor, 35,000 pcs per day i.e. **8,75,000 pcs per month.**

### Garments/ Fabric Produced:

T-shirt, Polo-shirt, Sport wear, Legging, Jogging set, Hoody, Nightwear set, Sweat, Fleece Jacket

T-shirt set, all kinds of basic and fashionable teams for Children (kids and babies), Ladies and Men.

Cotton/Elastin, Mélange, y/d stripe of cotton, viscose, polyester, CVC, PC, Pique.

## **GARMENTS SECTION RODDUR APPARELS LTD. UNIT-2**

---

### **Available Machines:**

#### **Sewing Floor:**

- 200 sewing machines (8 lines x 24 m/c per line);

**BRAND: Jhuki, Brother, Pegasus, Japan** (machines selection is such to cover most of the stitching facilities for the knit garments)

**Siruba (China).**

#### **Finishing Floor:**

- Thread sucking machines 8 nos,
- Full Steam Iron with vacuum table 18 nos.
- Automatic metal detector machine Brand Lock, UK.

### **Production Capacity:**

Garments/ Fabric Produced:

1 floor, 25,000 pcs per day i.e. 6250000 **pcs per month.**

T-shirt, Polo-shirt, Sport wear, Legging, Jogging set, Hoody, Nightwear set, Sweat, Fleece Jacket

T-shirt set, all kinds of basic and fashionable teams for Children (kids and babies), Ladies and Men.

Cotton/Elastin, Mélange, y/d stripe of cotton, viscose, polyester, CVC, PC, Pique.

**UTILITIES FACILITIES**

	<b>CAPACITY/ DETAILS</b>	<b>BRAND/ COUNTRY</b>
▪ Gas Generator	1 MW	Jenbacher Austria
▪ Steam Boiler	600 kg	Loose, Germany



# COMPLIANCE ISSUES

**Being a socially as well as environmentally responsible organization, we are very conscious regarding the well-being of our workers and the environment in which they reside. To ensure this we maintain the following policies and measures. These are broadly categorized under the following four broad sections:**

## **ETHICAL AND SOCIAL MEASURE:**

---

- 1.** All rules and regulation regarding workers' salary, benefit and appointments are maintained according to **Bangladesh Labor Law**.
- 2.** Workers' Participation and Welfare Fund (WPF) is established
- 3.** Fully computerized **attendance card** is maintained.
- 4. Protective equipment's** like masks, ear plugs, goggles, glass, boots etc are used on a production **floor** and store area as required. Signs and warnings are also posted on required re s to remind workers to wear protective equipment's.
- 5.** Entire factory facility is declared and maintained as **non-smoking zone**.
- 6.** All **chemicals substances** (both hazardous and non-hazardous) are clearly marked.
- 7.** Standard distance and **aisle-way** is maintained between each machine so that no obstruction is faced on the working floor.
- 8. Needle and sharp objects policy** is maintained
- 9. Metal detection policy** is maintained
- 10.** Workers are given regular trainings regarding **health and safety**, machines handling and sharp objects handling
- 11.** In-house **doctor and nurse** available.
- 12.** In-house **drinking water facility**. Regularly tested by appropriate authority.
- 13. Air emission, noise and light** is measured by appropriate authority and controlled **Accordingly** to ensure good working environment.
- 14.** Separate male/ female **toilet** and sufficient no of cubicle in each is maintained.
- 15.** All used toxic water is delivered to **ETP** through separate drain and biologically treated to suit the environment before emission. Certification and periodical tests are done by Environment Directorate Govt. of Bangladesh.

16. Available child care room, dry food canteen, dining room, separate training room and separate smoking area.
17. BSCI and Sedex (international certification) and factory license issues by Govt. of Bangladesh (local certification) maintained for past few years.

### **BUILDING SAFETY MEASURES:**

---

1. **There is no high rise factory building** within the factory premise.
2. 4 separate **pre-fabricated steel structured sheds** housing different departments (knitting, garments, utility) covering 11,000sqm floor space within a total area of 40,000sqm (15 acre) land area.
3. Each shed is used for a different function.
4. Appropriately designed, imported and install pre-fabricated steel building structure from Kirby, UAE.
5. Appropriately **foundation designed by certified engineers** for all buildings by Creators Designs Syndicate, a Bangladeshi engineering consulting firm.
6. All buildings are well-maintained with **proper ventilation** and sufficient number of **exits**.
7. Obtained **approval certificates for being used as garments** manufacturing factory from various required authorities.
8. Factory building approval got from the engineering division of Sreepur City Corporation.
9. Factory Inspector of Bangladesh approved the building layout including machine layout.

## **FIRE SAFETY MEASURES:**

---

- 1.** Updated **fire license** obtained covering whole factory premise from **Bangladesh Fire Service Department**.
- 2.** Required checklist as advised by Bangladesh Fire Service and Civil Defense Department are regularly maintained.
- 3.** Sufficient number of emergency exits, fire extinguisher, hose pipe, sand bucket, heat detector, fire alarms, emergency light and other **fire safety measures and equipments** are available on each factory floor according to its requirement.
- 4.** **Staircase** is required on garments floor. Two staircases, each 3m wide and of appropriate **slope** are maintained. Both staircases are on each end of the building and housed in an adjoining separate structure with the production floor.
- 5.** Sufficient number of windows and industrial fan on opposite ends are fitted on each building so that the total hot air volume inside the factory floor can be emitted outside within few minutes to ensure overall **ventilation**.
- 6.** All fire safety equipments are regularly checked internally to maintain good house-keeping.
- 7.** Sufficient number of full time in-house **Fire-Safety Officer** is appointed on each production floor.
- 8.** Fire Safety Officers are identified with their special dress. The name list with their photograph is posted on each floor.
- 9.** Monthly **fire drills** (day and night) are conducted according to approved emergency evacuation plan.
- 10.** **Evacuation plan** are posted on each floor both in pictorial and written (local language-Bangla).
- 11.** Regular classroom training to familiarize both workers (old and new) and staff about the emergency evacuation plan.

## ELECTRICAL SAFETY MEASURES:

---

1. The whole factory premise is within **buss bar trucking system**.
2. All electrical wirings have been constructed as per approved designs by appropriate authorities.
3. All **electrical wires** are covered and properly insulated throughout the factory floor.
4. All electrical appliances (iron, control panel etc) have insulated rubber mats in front, standing on which operators can use the appliances.
5. Rubber insulation and steel sheets have been used to protect wires from various vermin and other unwanted pests.
6. No electrical connections are given in any of the fabric storing and finished garments stores.
7. Certified and trained officer for **Boiler** from Boiler Directorate, Govt. of Bangladesh.
8. Certified and trained engineers are appointed to carry out all **electrical related works**.
9. Certification and license from Energy Regulatory Commission, Govt. of Bangladesh for **Generator** usage.

## QUALITY ASSURANCE

---

1. Dedicated quality assurance team on each production floor
2. **In house laboratory** equipped with equipment's for basic fabric and garments testing.
3. Regular in house **workers' training program** is held to improve quality
4. **Periodical testing** on garments and fabrics produced to check with the requirements.
5. Machines and weighing equipment's are **regularly calibrated** according to fabric requirements.
6. In house **pull testing facilities and equipment's** are available to satisfy requirements from both customer and international standards.
7. In house **metal detection equipment's** are available and maintained to determine conformity of metal free garments before packing into cartons.
8. **Proper records and registry** for incoming and outgoing is maintained in accessories **warehouse** for each order to eliminate errors.

# FACTORY MASTER PLAN

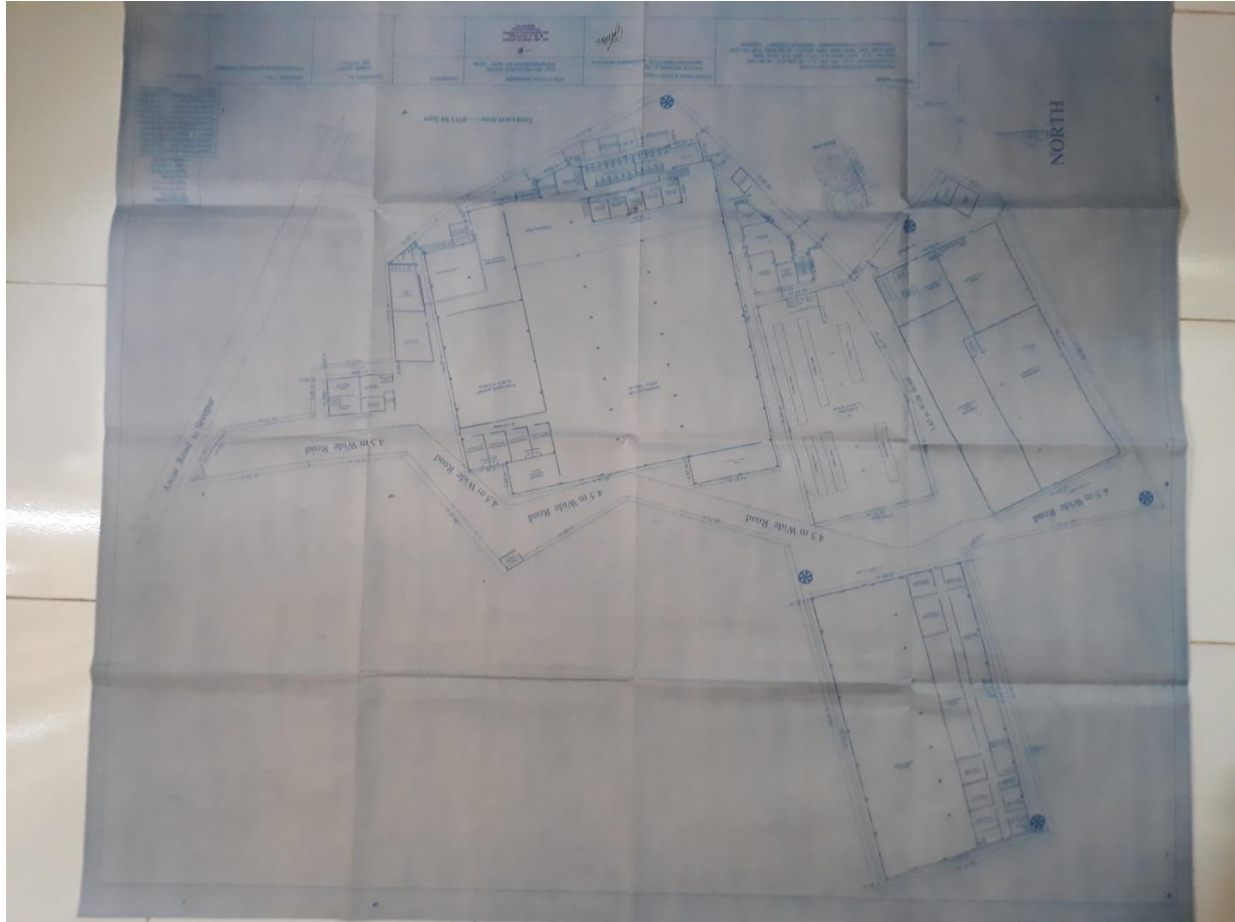

# GARMENTS RANGE

## Boys Items:

























**MENS T - SHIRT:**





**POLO SHIRT:**







**Fleece:**



# LIST OF MACHINERIES

## KNITTING SECTION

### S/J Circular Knitting M/C , 28/G and 24/G (full feeder lycra attachment)

30" dia 18 nos	Brand:	LISKY TAIWAN
20" dia 1 nos	Brand:	LISKY TAIWAN
22" dia 2 nos	Brand:	LISKY TAIWAN
26" dia 1 nos	Brand:	LISKY TAIWAN

### Interlock Circular Knitting M/C ,24/G

30" dia 2 nos	Brand:	LISKY TAIWAN
---------------	--------	--------------

### Rib Circular Knitting M/C, 18/G

30" dia 6 nos	Brand:	LISKY TAIWAN
---------------	--------	--------------

## GARMENTS SECTION

### Sample Section :

20	Sewing M/C	Capacity:	2,080 pcsper month (both basic and fashion items)
----	------------	-----------	---

### Cutting Section:

CAD System (3 Set)	Brand:	Winda, China
CAM (automatic cutting m/c 1 set)	Brand:	Winda, China
Automatic Spreader(2 set)	Brand:	Mac, Japan

### Sewing Section:

18 sewing lines x 24 m/c per line= 3450 m/c Brand: Japanese originated brands

Single Needle	Feed of arm	Button hole	Cylinder bed	Bartack
Overlock	ElasticJoint	Button Stitch	PMD Machine	Fussing
Flat lock	Pickoting	kansai	Snap Button Fixer	Heat Press

### Finishing Section:

36 Set vacuum iron table with full steam iron 8 Thread Sucking Machine Automatic Metal Detector Machine, Brand: Lock, UK Pull testing Machine

## Company at a Glance

Company Name :	Ratool Apparels Limited
Type of Business :	Manufacturer and Exporter
Legal Status :	Private Limited Company
Year of Establishment :	2011
Contact Person :	Md. Mosharraf Hossain Chairman
Contact Number :	+880 1713046497
Head Office :	DOHS Baridhara.
Factory :	Anser Road Vagnahati, Sreepur, Gazipur.
Email :	<a href="mailto:hossain@ratoolapparels.com">hossain@ratoolapparels.com</a>
Web :	<a href="http://www.ratoolapparels.com">www.ratoolapparels.com</a>
Bank :	ISLAMI BANK BANLADESH LIMITED
SWIFT Code :	IBBLBDDH207
Bank :	MERCANTILE BANK LIMITED
SWIFT Code:	MBLBBDDH017
<b>Production Capacity Garments:</b>	<b>30000 pcs per day</b>
<b>Knitting:</b>	<b>2.5 tons per day</b>
<b>Embroidery :</b>	<b>6500 pcs per day</b>
<b>Print :</b>	<b>15000 pcs per day</b>
<b>Factory Own Space :</b>	<b>20 Acres</b>
<b>Turnover:</b>	<b>\$10 million</b>
<b>Total Manpower :</b>	<b>1800 person</b>

## LIST OF CERTIFICATION



LIST OF CLIENT



*Des histoires plein la tête*

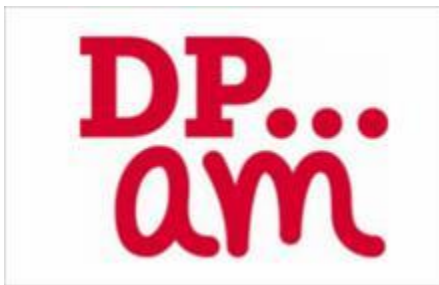



**LA HALLE**  
c'est vraiment vous



## **CONTACT DETAILS**

Contact Person Name: Md. Mosharrof Hossain  
Designation: Chairman  
Contact Info : +880 1713046497  
Email: [hossain@ratoollapparels.com](mailto:hossain@ratoollapparels.com)

### **HEAD OFFICE**

Address: House# 288, Road# 4,  
Baridhara DOHS, Dhaka  
Dhaka – 1230  
Bangladesh

### **FACTORY**

Address: Ansar Road, Vangnahati  
Sripur, Gazipur  
Bangladesh



# FACTORY LOCATION MAP

